

SINGLE DOOR VERTICAL FREEZER

USER MANUAL

SLIM N



THIS MANUAL INCLUDES FOLLOWING MODELS:

SLIM N

Contents

| | |
|---|---|
| 1. Intended Use of the Product..... | 5 |
| 2. Safety Warnings | 5 |
| 3. Procedures to be Completed Before the Assembly and First Operation of Your Appliance;..... | 6 |
| 3.1 After Assembly and Installation WARNING | 7 |
| 4. Regarding Refrigerator's Operation Performance WARNING | 7 |
| 5. General View of Your Appliance | 8 |
| 6. Installation and First Operation of Your Appliance..... | 9 |
| 6.1. Electrical Connection | 10 |
| 6.2. Operation of Your Cooler | 10 |
| 6.3. Setting the interior temperature of your cooler..... | 10 |
| 7. Putting Food on Your Cooler | 11 |
| 8. Defrosting Operation | 11 |
| 9. Products with Digital Thermostat | 12 |
| 10. Turning off Your Appliance | 12 |
| 11. Cleaning, Maintenance and Transportation of Your Appliance..... | 13 |
| 11.1. Cleaning..... | 13 |
| 11.2. Maintenance | 13 |
| 11.3. Transportation | 13 |
| 12. Things to do before contacting Authorized Service in case of a fault | 14 |
| 13. Liability Limitation..... | 14 |
| 14. Warranty and Authorized Workshop Services..... | Hata! Yer işareti tanımlanmamış. |
| 15. Standards of Conformity for the Appliance | 15 |
| 16. Rights of Choice of the Customer | Hata! Yer işareti tanımlanmamış. |
| 17. Type Label | 16 |

Dear Customer,

You have purchased a quality GreenCooler product by preferring the Single Door Vertical Cooler.

Your device will serve you for long years as long as you display the necessary care and maintenance.



To get to know your appliance and take advantage of all your product's functions, please read the instructions on this manual carefully.



This manual includes warnings to prevent the appliance from becoming nonoperational, loss of life and property, and injuries while using the device.



These refer to warnings and cautions regarding the your appliance's connection to the electricity line.



Read The User Manual.

1. Intended Use of the Product

The product you have purchased is designed and manufactured solely for the purpose of preserving packaged and frozen products.

2. Safety Warnings



- Always have the demonstration and installation of your appliance performed by an authorized GreenCooler service.
- Your product shall be void of warranty if you have the demonstration and installation of your appliance performed by any service other than the authorized GreenCooler service and if a malfunction occurs.
- Consider all warnings provided on your appliance and in the user manual, and keep this manual for future reference to some problems that may occur.
- This appliance may be used by children above age of 8 and persons with limited physical, perceptual or mental abilities or persons with a lack of experience and knowledge if they are supervised or given instructions on the operation of the appliance and any relevant risks that may be encountered. Children shall not play with the product. Cleaning and user maintenance of the appliance shall not be performed by unattended children.
- Power cord of your cooler is fitted with a special grounded plug. This plug shall always be used with a special grounded power outlet with a rating of 10 Amperes. If no such outlet is available, have a qualified electrician install it.
- Do not use multi-sockets or an extension cord.
- Do not plug in any plugs with damaged, worn or torn cords to the outlet
- Do not pull, bend or damage the power cord
- Do not replace any electrical component inside the Cooler, and contact the Authorized Service when required.
- Do not plug the appliance to the outlet by hand to prevent any shocks.
- Do not allow children to play with the appliance or hold on the appliance and hang themselves. Do not hang on the doors and racks.
- Do not place explosive or flammable materials in your cooler for your safety.
- Do not allow wild animals or pets to get inside the product or play around it.
- This may damage your product or may cause injuries or death of your animal. Moreover, wild animals or pets may cause fire by damaging the wiring.
- Do not allow children to get into the product or play around it.



Please read the user manual before installing and operating your appliance. Our company shall not be held responsible for any damage due to improper operation.

3. Procedures to be Completed Before the Assembly and First Operation of Your Appliance;



- Do not place the your product under direct sunlight or within influence area of a stove, radiator, furnace, oven, infra-red heater or air conditioner. Otherwise, the your product may perform poorly, get damaged or become inoperable.
- Electrical installation shall conform with the national regulations.
- Your electrical installation shall be equipped with residual current relays and fuses to prevent the risk of electrocution and fire.
- In case of usage without grounding, our company shall not be responsible for any faults and damages that might occur.
- Place your product away from moisture, where air circulation is provided.
- Always clean inside of your product prior to first use.
- After placing your product, allow at least two (2) hours without moving it before starting to use.
- If your cooler is installed in extreme cold conditions, waiting period before operation shall be at least Four (4) hours.
- Do not use the product in any other way than what this product is designed for.
- Your product is designed for indoor use. Do not use your product outdoors.
- Installation, placement, maintenance and cleaning of your product shall be performed as described in the manual. Do not act against the manual. Warranty shall be void due to misuse in case of any damage to your product caused by such operation.
- Frost shall be increased for products, of which the doors are kept open or frequently open and closed, and the appliance shall not perform the cooling operation. Thus, open the door of your product when it is required only. Ensure that the door of your product is closed when you do not require.
- Place the cooler on the ground and check if it is level with a spirit level. Adjust using the leg bolts in case of any inclination to any side. Place your cooler on its place where it shall be used after completing the setting procedure.
- Do not change the position of the product when it is loaded or do not carry it by pushing it on its castors. Do not push your cooler over cables or door thresholds to prevent damage to the castors even if the cooler is empty. Never push your cooler if the ground is not level, and if there is an inclination or stairs present in the vicinity.



Your product is set for 220 - 240 Volts and 50 Hz mains power. Use of incompatible voltage may cause your cooler to become inoperable or fire.



In the event of a sudden power outage, unplug your product. Plug your product 20 minutes after the interruption has ended to operate your product again. High voltage that occur when the power is restored may cause fire or damage to your product.

3.1 After Assembly and Installation WARNING



- Be very careful as an impact by a sharp, tipped object or contact of a hot material to the glass part of the product with glass doors may cause the glass to break.
- In order to avoid your appliance from sliding or overturning, place the appliance on a level flat surface.
- Use your product in the operation position described in the user manual.
- Do not expose your product to direct sunlight.
- Handle and store your product in normal operation position only to protect your product against damage. Otherwise, warranty rights shall be void.
- Keep the accessories, nylon bags containing the operating manual and the key of the cooler cabinet provided with the cooler in a place where they cannot be reached by children.
- Keep the roof of your appliance empty.

4. Regarding Refrigerator's Operation Performance WARNING



- If R600a or R290 refrigerant is used in your cooler; (you may see this information on the Rating plate on the cooler.) R600a refrigerant is an environmentally-friendly gas used in effective cooling technology. This gas may catch fire under certain conditions. You shall follow the rules below to ensure normal operating conditions.
 - Keep the front of any fans both inside and outside of the cooler to prevent blockage.
 - Do not use any mechanical tools (knives, screwdrivers, etc.) to accelerate thawing in case of frost.
 - Do not damage the cooling circuit.
 - Do not use electrical appliances and tools inside the food storage compartment of the product.
 - Installation of the appliance shall be performed by authorized personnel only to reduce the risk of flammability.
 - Do not allow anyone other than the authorized service intervene the appliance for maintenance, repair or any other reason.
 - Unplug the appliance and switch to defrosting position against possible frost or icing.
 - Prefer original components for any parts to be replaced on the product.

5. General View of Your Appliance

- 1-Door
- 2-Wot Evap
- 3-Wot Evap Bracket
- 4-Interior Lighting
- 5-Motor Compartment
- 6-Adjustable Feet
- 7-Mechanic Lock (optional)
- 8-Canopy
- 9-Thermostat (optional)
- 10-Fan Switch
- 11-Power Led (optional)
- 12- Light Switch (optional)
- 13-Digital Thermostat (optional)
- 14-Fan

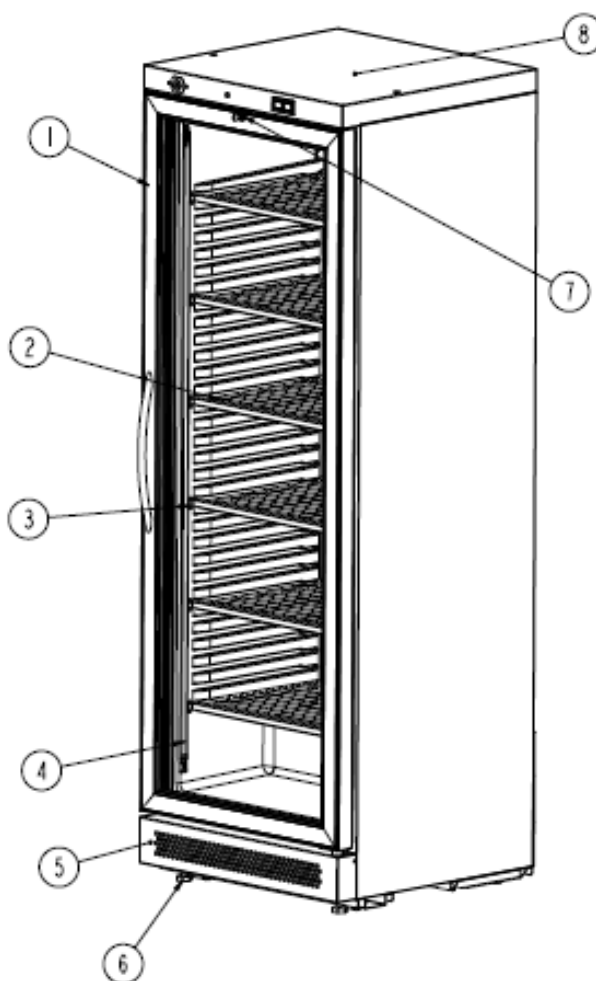
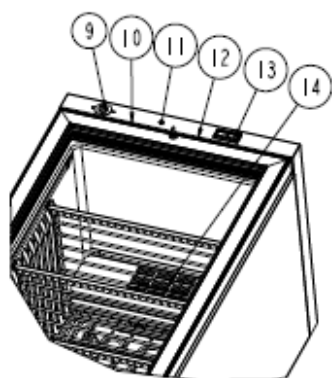

6. Installation and First Operation of Your Appliance



Take off and remove all package materials and lower wooden pallet of your product before placing it. (It may be required to lift the cooler to remove the base bracket).

Install spare parts provided inside your appliance (Wire racks, Rack bars, etc.) as per the installation instructions. Use only genuine GreenCooler spare parts. Non-genuine spare parts may cause risks for you and may damage your product.

Place your product where you desire. Consider the placing rules specified in the manual during placement.

Level your product laterally and vertically with a spirit level. Perform the levelling procedure with the adjustable legs on the front lower part of your cooler. (Fig. 1)

For models with castors (optional), castor brakes (optional) shall be locked after placing the products or if no castor brake is available, it shall be ensured that the appliance does not move.

- Place your cooler by pushing it rearward.
- Place your product so that it is inclined in any way and that it is standing on its legs or castors and then operate it.
- Make sure that you do not close the fan intake outlet while placing products inside the cooler.
- Do not place your product outdoors so that it shall be exposed to weather conditions. (on a street, lane, etc.)
- Do not place materials such as cardboards, boxes, etc. in front of the lower blinds to ensure proper cooling of your product.
- Do not expose to direct sunlight. Operating period shall be increased if sunlight hits the glass of your cooler. And this means that the power consumption shall be increased.
- Make sure that there is a clearance of 150 mm (15 cm) between the wall and the rear side of your cooler when you are bringing the product close to the wall. Air circulation should be ensured at the rear area of the coolers for efficient use.
- Your cooler provides best cooling performance in the conditions specified below as per the climate class. Thus, ensure that the environment where your cooler shall be used conforms with this temperature ranges.

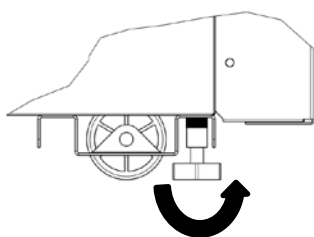

Fig. 1

Your product provides best cooling performance in the conditions specified below as per the climate class. Thus, ensure that the environment where your product shall be used conforms with this temperature ranges.

For Commercial Products:

| Climate Class | Temperature Range | Humidity |
|---------------|-------------------|----------|
| Class 3 | 16 °C to 25 °C | 60% Rh |
| Class 4 | 16 °C to 32 °C | 65% Rh |
| Class 5 | 16 °C to 41 °C | 70% Rh |

6.1. Electrical Connection

WARNING



Do not plug your appliance to a multi-socket or do not use an extension cord

Your product is not equipped with an on/off switch.

Do not allow the cables of your product connected to the mains to contact hot surfaces.

Outlet that shall be used shall always be grounded. It the outlet that shall be used shall also be protected with a proper fuse with a rating of 10-16 A minimum. Be sure to seek help from our technical service or a qualified electrician regarding the insurance that must be present in the network to which your outlet is connected.

The mains voltage and frequency must be the same as the value written in the label information on the inside of your product. If mains power is far below or above the specified value, have the desired voltage by using a voltage regulator. You can get help from a qualified electrician.

Do not put the cable of your product on passage routes. These may cause injury to you and damage to your cooler. If the power supply cable is damaged, it must be replaced by its manufacturer or authorized technical service or any other personnel qualified at the same level, in order to avoid any dangerous situation.

6.2. Operation of Your Cooler

- Clean the inside of your product and all of its accessories before operating your product for the first time.
- If your product has been shaken a lot during transport and placement, allow at least two (2) hours before starting to use your cooler. Thus, compressor oil shall be returned if it has entered the system. You may damage the compressor if you operate the cooler without considering this.
- Plug your product to an outlet that is installed as per the legislation and that supplies a 220 - 240V / 50 Hz alternative current only.
- You shall hear a slight compressor noise when your product is operated.
- Fan inside your product shall stop when you open the door of your cooler.

6.3. Setting the interior temperature of your cooler

- Temperature settings of your appliance is performed in our factory for operation in suitable conditions.
- Temperature for the preservation of the food is adjusted with the thermostat by observing it from the thermometer on your cooler (optional). However, it is best to keep this at factory setting.
- Internal temperature of your cooler may be adjusted by rotating the thermostat switch. When the thermostat is in position "6", the temperature inside the cooler will be on the lowest level and when in position "1", it will be on highest level.
- Internal temperature of your product may be set between -18 and -24 C.

7. Putting Food on Your Cooler

You may load the food in your cooler when it has reached the desired temperature as empty. (If your product model is equipped with a thermometer, you may control the internal temperature here.)

- Operate your storage cooler at least 6-8 hours without load before loading your food.
- Leave at least 3-5 cm of space between the upper shelf and the products you have loaded to ensure air circulation.



Do not put hot food in your product to cool the food.
Do not put materials that shall not be cooled in your product.
Make sure to put frozen products inside your appliance.

8. Defrosting Operation

Your product is not equipped with a special defrost function. Your appliance shall thaw the icing on it automatically during thermostatic operation.

While your appliance prevent frosts by itself, high temperatures and humidity and frequent operation of your appliance may increase the rate of frost. The more the frost, the more the operation time. And this causes an increase in the power consumption. Turn off your appliance and make sure that the frost is removed in such a case.



REMEMBER!

An evaporator without frost shall always operate with high efficiency.

9. Products with Digital Thermostat

Control unit flashes for a few seconds to check if all connections are made correctly when you plug your appliance on models with digital thermostat, this is a normal condition. Then, the temperature value at that time shall be displayed on the screen.



Please do not attempt to change the settings.



Carel Easy



Bottom On-Of: Lamp status changes when it is hold pressed for 0.5 seconds. If the lamp is on, "OFF" is displayed on the screen as the lamp shall be turned off; and if the lamp is off, "ON" is displayed on the screen as the lamp shall be turned on.



Temperature Setting Bottom : When it is pressed for 0.5 seconds, the SET sign flashes on the screen, and it is brought to the desired set temperature with the up and down arrows.



Defrost Bottom : When pressed for 3 seconds, it enters defrost mode, stops the compressor for 30 minutes.

10. Turning off Your Appliance

- Put the food inside the appliance to a suitable place before turning off your appliance.
- Unplug the power cord from the mains socket.



When your appliance is powered down, the ice formed inside the cooler will melt. Since there is no drainage system in the cooler, flowing water must be taken from the lower shelf with the help of a cloth. Otherwise, the water flowing through the cooler may damage the environment (parquet, floor, carpet, etc.). It can make the floor slippery and cause injuries.

Perform the following if your product shall not be used for a long period;

- Clean your product.



At the end of the cleaning, do not close the doors before the interior of the cooler is completely dry, the moisture remaining inside may cause darkening and corrosion.

If your product will remain in a closed environment after turning it off;



Do not cover your product with plastic material. A plastic material may cause your appliance release odour and perspiration as it does not permeate air through it. Perspiration may cause rusting. If you do not keep your appliance with its door open, it may release odour.

Do not unplug your product for saving power if you shall go to a short vacation or you shall not use your cooler for a short time.

11. Cleaning, Maintenance and Transportation of Your Appliance

11.1. Cleaning

Unplug your cooler from the outlet before cleaning.

Before performing internal cleaning, wait until the temperature of the inner parts of the appliance increases up to the ambient temperature.

Wear protective gloves during cleaning and maintenance. This will protect you against injuries.

Remove accessory parts from the appliance. Perform cleaning by using a soft cotton cloth and warm water.

Dry it by using a dry cotton cloth. If it is not dried, it may turn black in time.

Ensure that the inner surface is not wet or moist after cleaning.

You can reload your food two (2) hours after operating based on the type of operating specified within this manual.

External cleaning shall be performed with a cotton cloth and warm water.

Prevent cleaning water from entering the front dashboard and illumination section during cleaning.

Clean the door seal using only clean soapy water.

11.2. Maintenance

The appliance does not require periodic maintenance.

11.3. Transportation

Carry your product as per the instructions specified on the package. Do not carry your appliance as horizontal, vertical or in an inclined position or with its door open.

Protect your appliance against impacts while carrying.

Do not carry your appliance as plugged or while it is loaded.

To prevent any accident or damage to your product by falling or sliding, secure your product to the transport vehicle during transportation.

12. Things to do before contacting Authorized Service in case of a fault

| PROBLEM | CAUSE | SOLUTION |
|---|--|---|
| Your appliance does not operate, No noise or just the fan noise. | It may be caused by the thermostat. It may be unplugged Fuse may be blown or faulty. Condenser fins may be dirty or clogged. | It shall operate again when it reaches the proper temperature. Insert the plug correctly. Contact a licensed electrician to clean the condenser fins. |
| Internal temperature of your appliance is high | Ambient temperature is very high or thermostat setting is incorrect. Rear part is very close to the wall, ventilation blind is blocked or its front is covered. Condenser fins are very dirty. | Take your appliance to a place where ambient temperature is lower. Bring the clearance between the appliance and the wall to the required distance. Clean the condenser fins. |
| Internal temperature of your appliance is very low | Thermostat setting is incorrect | Reset the thermostat. |
| Lamps of your appliance does not illuminate or only one lamp illuminates. | Lamp or adaptor is faulty | Contact the authorized service. |
| Excessive perspiration inside the appliance and on the window | Drainage pan exit hole may be clogged for internal perspiration. Humidity level of external environment is higher than 65% for perspiration on the window | Clean the water drainage hole. Take your appliance to a place where humidity is lower. |
| If odour occurs in your appliance | Drainage pan may be dirty; Interior of the cooler is not clean enough. | Clean your appliance as described in the user manual. |

13. Liability Limitation

All technical information, instructions of use, information on the operation and maintenance of the device provided in this manual includes the latest information regarding your product. Manufacturing company does not assume any responsibility for damages and injuries that might be caused due to not observing the instructions in this user manual, using the appliance outside its intended use, unauthorized repairs, unauthorized modifications on the appliance and using spare parts not approved by the manufacturer.

14. Standards of Conformity for the Appliance

Coolers specified in the user manual are manufactured and tested as per the

TS EN ISO 23953-1

TS EN ISO 23953-2

TS EN 60335-2-89

IEC 60335-2-89 Standards, and

2006/95/EC

2004/108/EC

Directives.

Complies with EEE Regulation. (Regulation on the Restriction of the Use of Certain Hazardous Substances in Electrical and Electronic Equipment)

Complies with AEEE Regulation. (Directive on the Control of Waste Electrical and Electronic Equipment)

Dear Customer,

This warranty provided by ÖZTAŞ A.Ş. does not cover the repair of malfunctions caused by failure to use your cooler for its normal and intended use, and the situations below are also excluded in the warranty:

- Damages and malfunctions due to incorrect use,
- Damages and malfunctions occurring during the loading, unloading and handling after the product is delivered to the customer,
- Damages and faults that occur because of undervoltage or overvoltage, faulty electrical installation, using the appliance with a voltage other than the voltage specified in its data plate,
- Damages and faults that occur because of fire or lightning strike,
- The malfunctions occurring due to the product being used against the conditions specified in the user manual.
- Paid repair service is required for failures listed above.
- Installation and transportation of the product is not included in the price.
- The responsibility to complete the warranty certificate and to submit it to the consumer is placed on the sellers, dealers, agencies or agents from whom the consumer purchased the good.
- Warranty is applicable for the period specified in the warranty certificate and for the faults that occur on the product; any other rights may not be claimed based on the warranty certificate.
- This warranty is void if the warranty certificate is damaged, the original serial number on the product is removed or changed, damaged.

15. Type Label

Since the technical data for the product differs in each product, it is indicated on the Type label on the cabinet.
The type label is located on the inside of your cabinet.
Below is the Type label image.

| TYPE LABEL | | |
|---|--|---|
| MODEL | |  The image shows a template for a Type Label. It features a vertical line on the left side, a CE mark, a RoHS logo (a green checkmark with the text 'RoHS'), and a crossed-out trash can icon. |
| Type | | |
| Climate Class | | |
| Power /Current W | | |
| Voltage / Frequency V/Hz. | | |
| Lamp Power W | | |
| Refrigerant | | |
| Maximum Rack Weight Kg | | |
| Internal Dimensions of the Product (w*d*h)(mm) | | |
| External Dimensions of the Product (w*d*h)(mm) | | |



MONDIAL FRAMEC srl
S.S. 31, n. 34
15040 Mirabello Monferrato (AL)
info@mondialframec.com
www.mondialframec.com
Tel +39 0142 235211
VAT# IT02533520066